

概述 Summary

- > 单组输出：功率15W
Single output: power 15W
- > 输入电压：85 ~ 264VAC 120 ~ 370VDC
Input voltage: 85 ~ 264VAC 120 ~ 370VDC



常见规格 General Specification

17.5 X 90 X 54.5mm

性能 Specification	型号 Model	HDR-15-5	HDR-15-12	HDR-15-24	HDR-15-48
直流输出电压、电流 DC output voltage, current		5V 0~2.4A	12V 0~1.25A	24V 0~0.63A	48V 0~0.32A
纹波及噪音 Wave and noise		80mVp-p	120mVp-p	150mVp-p	240mVp-p
进线稳定度 Inlet wire stability		±1%	±0.5%	±0.5%	±0.5%
负载稳定度 Load stability		±1%	±0.5%	±0.5%	±0.5%
效率 Efficiency		78%	83%	84%	84%
直流电压可调范围 Adjustable range for DC voltage		±10%	±10%	±10%	±10%
输入电压范围 Input voltage range	85~264VAC 120~370VDC 47~63Hz				
冲击电流 Impact current	冷启动电流 Cold start current 35A/115VAC 65A/230VAC				
过载保护 Overload protection	105%~160%切断输出，自动恢复 105%~160% cut off the output, automatic recovery				
其他保护 Other protection	过流保护/短路保护 Overcurrent protection / Short-circuit protection				
启动、上升、保持时间 Setup, rise, hold up time	800ms, 60ms, 50ms/230VAC 满负载 at full load				
耐压性 Withstand voltage	输入输出间：1.5kV I/P-O/P: 1.5kV				
隔离电阻 Isolation resistance	输入输出间 输入与外壳间 输出与外壳间：500VDC/100MΩ I/P-O/P I/P-FG O/P-FG: 500VDC/100MΩ				
工作温度 Working temperature	-10°C ~ +50°C				
尺寸 Dimension	17.5×90×54.5mm				
重量 Weight	0.078kg				
包装 Packing					

外形尺寸 Overall dimension(mm)

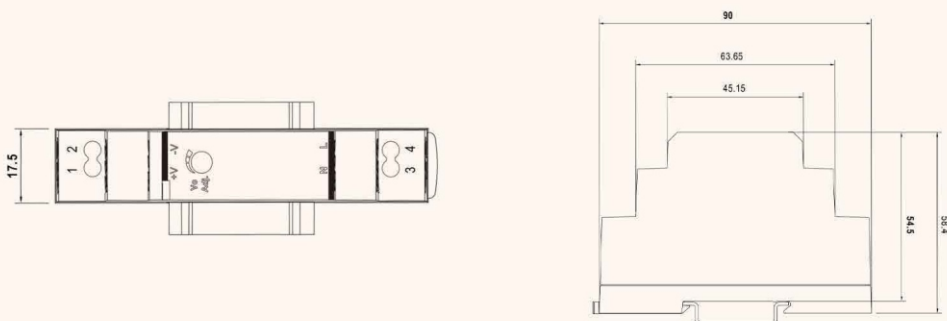

概述 Summary

- > 单组输出：功率30W
Single output: power 30W
- > 输入电压：85 ~ 264VAC 120 ~ 370VDC
Input voltage: 85 ~ 264VAC 120 ~ 370VDC



常见规格 General Specification

35×90×54.5mm

性能 Specification	型号 Model	HDR-30-5	HDR-30-12	HDR-30-24	HDR-30-48
直流输出电压、电流 DC output voltage, current		5V 0~3A	12V 0~2A	24V 0~1.5A	48V 0~0.75A
纹波及噪音 Wave and noise		80mVp-p	120mVp-p	150mVp-p	240mVp-p
进线稳定度 Inlet wire stability		±1%	±0.5%	±0.5%	±0.5%
负载稳定度 Load stability		±1%	±0.5%	±0.5%	±0.5%
效率 Efficiency		78%	84%	86%	86%
直流电压可调范围 Adjustable range for DC voltage		±10%	±10%	±10%	±10%
输入电压范围 Input voltage range	85 ~ 264VAC 120 ~ 370VDC 47 ~ 63Hz				
冲击电流 Impact current	冷启动电流 15A/115VAC 30A/230VAC Cold start current				
过载保护 Overload protection	105% ~ 160%切断输出，自动恢复 105% ~ 160% cut off the output, automatic recovery				
其他保护 Other protection	过流保护/短路保护 Overcurrent protection / Short-circuit protection				
启动、上升、保持时间 Setup, rise, hold up time	800ms, 60ms, 50ms/230VAC 满负载 at full load				
耐压性 Withstand voltage	输入输出间：1.5kV I/P-O/P: 1.5kV				
隔离电阻 Isolation resistance	输入输出间 输入与外壳间 输出与外壳间：500VDC/100MΩ I/P-O/P I/P-FG O/P-FG: 500VDC/100MΩ				
工作温度 Working temperature	-10°C ~ +50°C				
尺寸 Dimension	35×90×54.5mm				
重量 Weight	0.12kg				
包装 Packing					

外形尺寸 Overall dimension(mm)

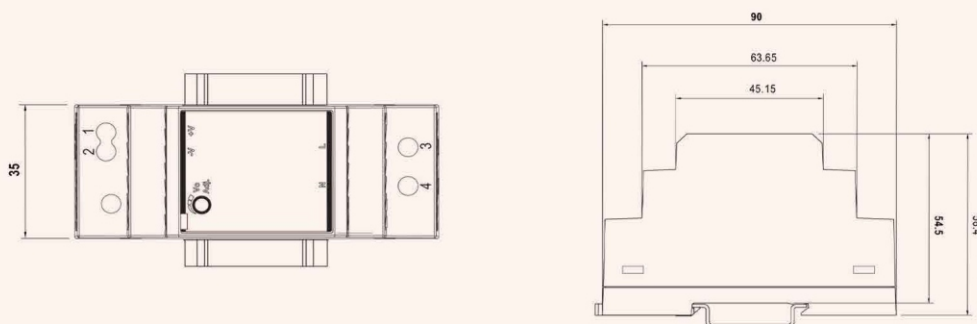

概述 Summary

- > 单组输出：功率60W
Single output: power 60W
- > 输入电压：85 ~ 264VAC 120 ~ 370VDC
Input voltage: 85 ~ 264VAC 120 ~ 370VDC



常见规格 General Specification

52.5×90×54.5mm

性能 Specification	型号 Model	HDR-60-5	HDR-60-12	HDR-60-24	HDR-60-48
直流输出电压、电流 DC output voltage, current		5V 0~6.5A	12V 0~4.5A	24V 0~2.5A	48V 0~1.25A
纹波及噪音 Wave and noise		80mVp-p	120mVp-p	150mVp-p	240mVp-p
进线稳定度 Inlet wire stability		±1%	±0.5%	±0.5%	±0.5%
负载稳定度 Load stability		±1%	±0.5%	±0.5%	±0.5%
效率 Efficiency		80%	85%	88%	88%
直流电压可调范围 Adjustable range for DC voltage		±10%	±10%	±10%	±10%
输入电压范围 Input voltage range	85~264VAC 120~370VDC 47~63Hz				
冲击电流 Impact current	冷启动电流 18A/115VAC 36A/230VAC Cold start current				
过载保护 Overload protection	105%~160%切断输出，自动恢复 105%~160% cut off the output, automatic recovery				
其他保护 Other protection	过流保护/短路保护 Overcurrent protection / Short-circuit protection				
启动、上升、保持时间 Setup, rise, hold up time	800ms, 60ms, 50ms/230VAC 满负载 at full load				
耐压性 Withstand voltage	输入输出间：1.5kV I/P-O/P: 1.5kV				
隔离电阻 Isolation resistance	输入输出间 输入与外壳间 输出与外壳间：500VDC/100MΩ I/P-O/P I/P-FG O/P-FG: 500VDC/100MΩ				
工作温度 Working temperature	-10℃ ~ +50℃				
尺寸 Dimension	52.5×90×54.5mm				
重量 Weight	0.19kg				
包装 Packing					

外形尺寸 Overall dimension(mm)

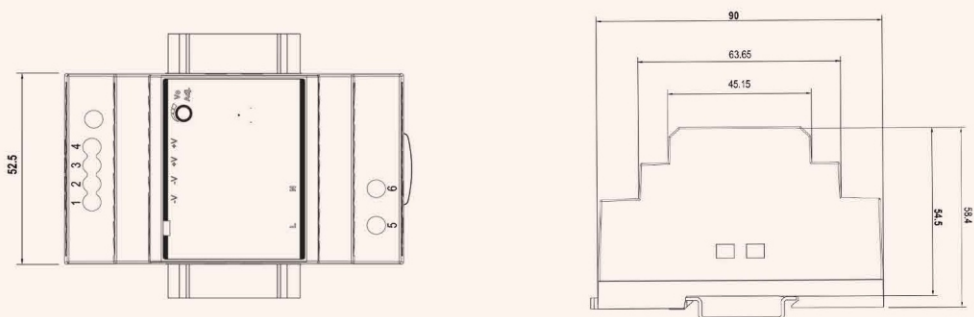

概述 Summary

- > 单组输出: 功率100W
Single output: power 100W
- > 输入电压: 85 ~ 264VAC 120 ~ 370VDC
Input voltage: 85 ~ 264VAC 120 ~ 370VDC



常见规格 General Specification

70×90×54.5mm

性能 Specification	型号 Model	HDR-100-12	HDR-100-15	HDR-100-24	HDR-100-48
直流输出电压、电流 DC output voltage, current		12V 0 ~ 7.5A	15V 0 ~ 6.6A	24V 0 ~ 4.16A	48V 0 ~ 2A
纹波及噪音 Wave and noise		120mVp-p	120mVp-p	150mVp-p	200mVp-p
进线稳定度 Inlet wire stability		± 1%	± 1%	± 1%	± 1%
负载稳定度 Load stability		± 1.5%	± 1%	± 1%	± 1%
效率 Efficiency		85%	86%	88%	88%
直流电压可调范围 Adjustable range for DC voltage		± 1%	± 1%	± 1%	± 1%
输入电压范围 Input voltage range	85 ~ 264VAC 120 ~ 370VDC 47 ~ 63Hz				
冲击电流 Impact current	冷启动电流 Cold start current 30A/115VAC 60A/230VAC				
过载保护 Overload protection	105% ~ 150%切断输出, 自动恢复 105% ~ 150% cut off the output, automatic recovery				
其他保护 Other protection	过流保护/短路保护 Overcurrent protection / Short-circuit protection				
启动、上升、保持时间 Setup, rise, hold up time	3000ms, 50ms/230VAC 满负载 at full load 3000ms, 50ms/115VAC 满负载 at full load				
耐压性 Withstand voltage	输入输出间: 1.5kV I/P-O/P: 1.5kV				
隔离电阻 Isolation resistance	输入输出间 输入与外壳间 输出与外壳间: 500VDC/100MΩ I/P-O/P I/P-FG O/P-FG: 500VDC/100MΩ				
工作温度 Working temperature	-10℃ ~ +50℃				
尺寸 Dimension	70×90×54.5mm				
重量 Weight	0.27kg				
包装 Packing					

外形尺寸 Overall dimension(mm)

